

KNOB AND LEVER TRIM

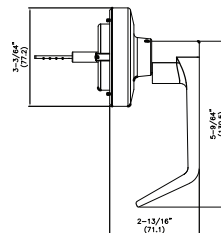
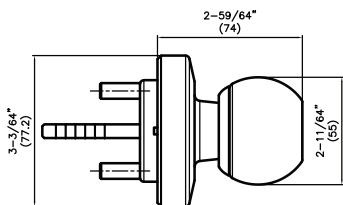

SPECIFICATIONS

- Functions:
 - Passage: Lever is always active, no cylinder
 - Storeroom: Always locked, cylinder retracts latchbolt
 - Classroom: Lever/knob retracts latchbolt, key locks or unlocks lever/knob
- Finish:
 - Lever:
 - Satin Chrome (C26D)
 - Black (C19)
 - Knob:
 - Stainless Steel (C32D)
- Reversible
- Cylinder included: 6 pin cylinder Schlage keyway

HOW TO ORDER

K R O M - 7 5 B 7 0 C 3 2 D

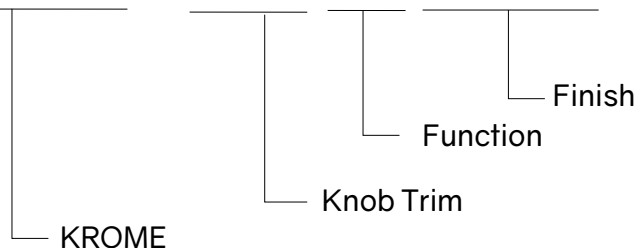

Item Number	Function	Finish
75B Knob	Passage (10)	Stainless Steel (C32D)
	Classroom (70)	
75L Lever	Storeroom (80)	Satin Chrome (C26D)
		Black (C19)

Notes: Passage (10) function only available for lever trim (75L)